

L-TYPE

ANCHOR HANDLING TUG SUPPLY VESSEL



MAERSK
SUPPLY SERVICE

Maersk Supply Service serves the offshore industry world wide with more than 60 vessels manned by approximately 2000 crew and supported by 220 onshore staff worldwide represented in all main deepwater regions.

The fleet includes craned offshore support vessels, anchor handling tug supply vessels, platform supply vessels and subsea support vessels.

Our focus areas are operations in ultra deep water, support of offshore platforms, rigs, barges as well as subsea services. Work scopes include amongst other things:

- Deep water anchor handling and mooring installations
- Subsea support/ROV support/Crane
- Ploughing/trenching operations
- General supply operations
- Special projects
- Rig moves

DNV class notation "CLEAN DESIGN"

The vessel has been designed and built to minimise the impact to the environment. It has the DNV class notation "CLEAN DESIGN" which has significantly more stringent levels for emissions to the air and discharge to the sea than either IMO or flag state require.

Low levels of NOX and SOX emissions to the air are achieved by more efficient engine combustion. Other ship systems which

could cause emissions, such as ship fire fighting and refrigeration, use agents which cause less harm to the environment. The most important factor in the ship to prevent pollution to the sea is the truly double hull design in which all oils and other potential pollutants are contained in tanks within the main hull and not in double bottom or side tanks.



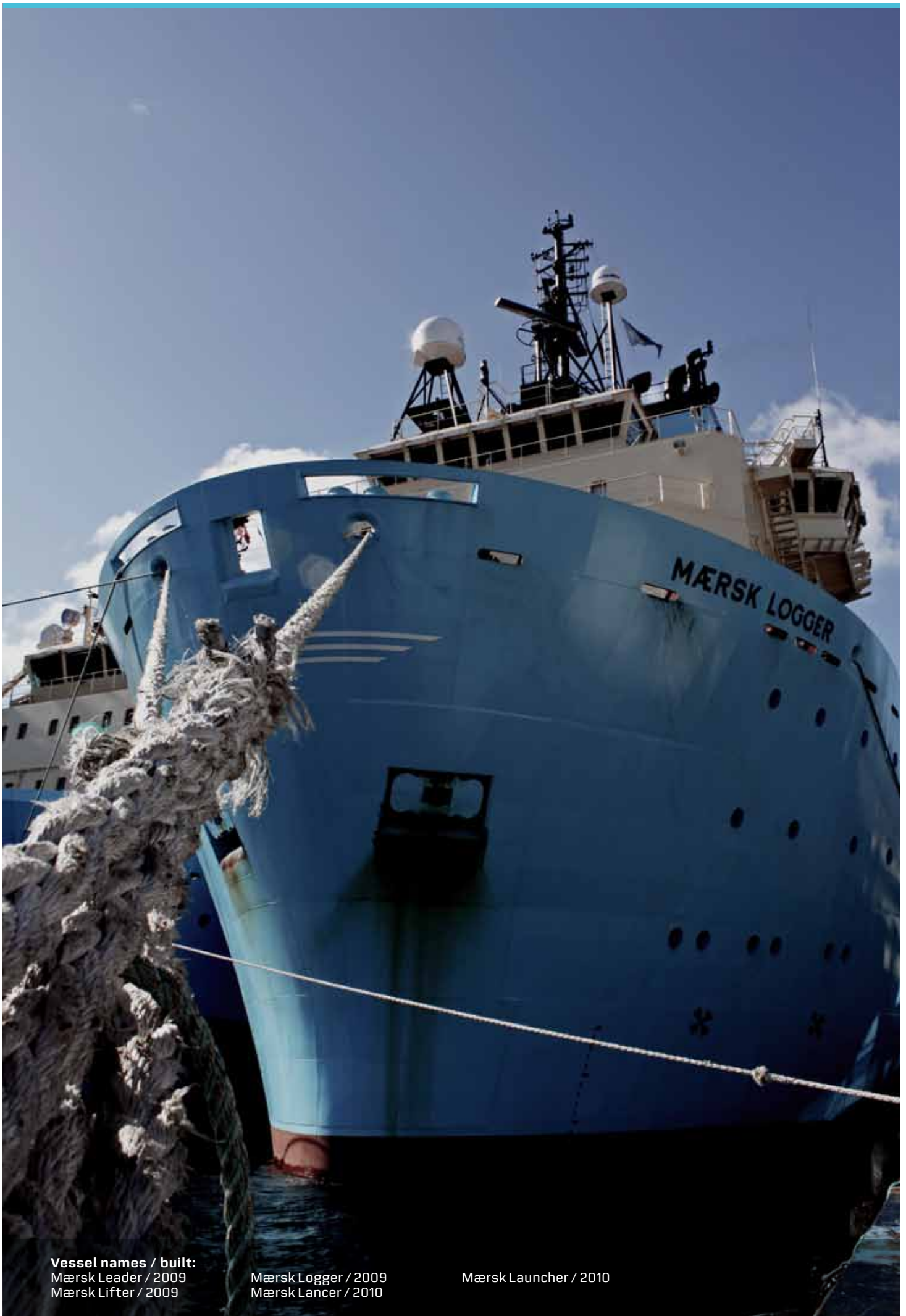

Vessel names / built:
Mærsk Leader / 2009
Mærsk Lifter / 2009

Mærsk Logger / 2009
Mærsk Lancer / 2010

Mærsk Launcher / 2010

Technical specifications

Classification

Classification	Lloyd's Register of Shipping
	+100 A1, Offshore Supply Ship/Tug, IWS
	+LMC, UMS, DP(AA)
	CLEAN DESIGN
	Letter of compliance with LR NAV-1

Deadweight/Tonnage

Deadweight	4,500 ts
Gross tonnage	6,821 gt

Dimensions

Length o.a./p.p.	90.30 m / 79.00 m
Breadth moulded	23.00 m
Depth moulded	9.50 m
Summer draft, max.	7.80 m
Freeboard at max. draft	1.70 m

Accommodation

Capacity	70 persons total incl. crew
	17 single cabins
	25 double cabins
	1 triple cabin

Towing/Anchor handling equipment

Make	Rauma
Type	Waterfall
Drums	2 with spooling device
AH drum	Max. pull 500 ts and 650 ts static brake
	Both drums are same size and divided in two compartments (1/3 and 2/3 length)
	Capacity of each drum 6,415 m x 84 mm wire in large compartment and 3,210 m x 84 mm wire in narrow compartment
Secondary winches	2 x 145 ts (Mærsk Lancer)
	Capacity 2,200 m x 180 mm fibre rope or 7,000 m x 77 mm wire
	Socket compartment 900 mm wide
Chain lockers	2 x 338 m ³
Shark jaws	2 x 700 ts Triplex
Stern roller	2 x 3.25 m x 4.00 m
Strong point	1,200 ts strong point and 250 ts Smit-Bracket type forward
Towing pins	2 x 300 ts Triplex
Wild cats	1 x 76 mm + 1 x 83 mm
Wire stopper pins	2 x 60 ts retractable

Upper deck

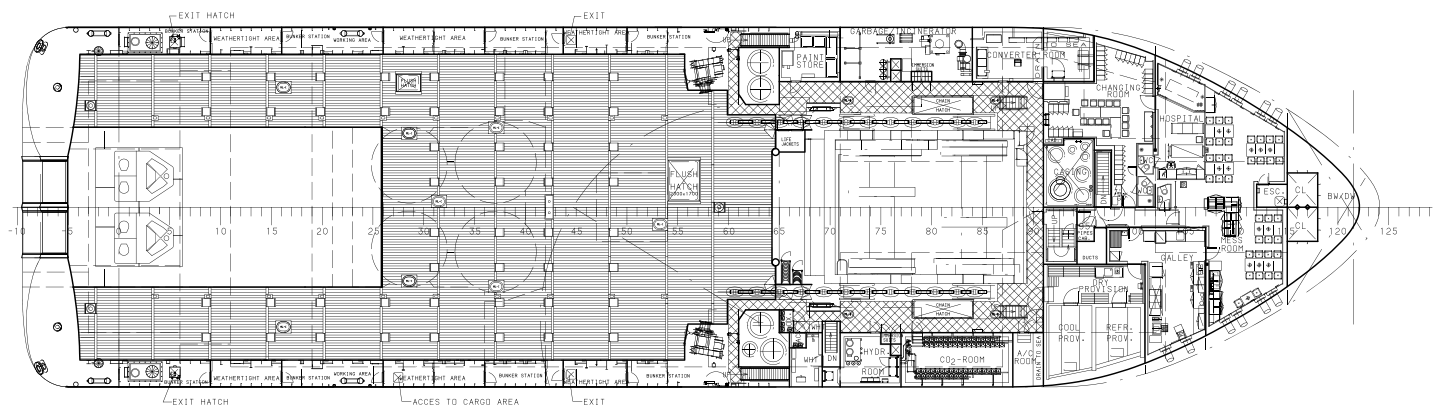

Deck load capacities	
Deck load	Aft 20.00 m = 15 ts/m ² , Fore 20.00 m = 10 ts/m ²
Deck length	42.10 m
Deck breadth	19.50 m
Deck area	800 m ²
Cargo rail height	3.40 m, partly closed

Deck equipment	
Capstans	2 x 15 ts (aft) 2 x 15 ts (fore)
Cranes	1 x hydraulic provisions crane – SB 15 ts / 10.00 m (harbour), 7.50 ts / 10.00 m (offshore) Certified for 3.75 ts man riding Max. outreach 14.00 m 2 x electrical/hydraulic travelling cranes running full cargo rail height 5 ts / 10.00 m (harbour) , 2.5 ts / 10.00 m (offshore) Max. outreach 16.00 m
Tugger winches	2 x 15 ts

Propulsion/Bollard pull	
Main engines	4 x Caterpillar/MAK 9M32C
Total BHP	23,500
Bollard pull	261-268 ts
Propellers	2 x controllable pitch with fixed nozzles
Rudders	2 x flap rudders
Shaft generators	4 x 2600 kW
Thrusters forward	2 x 2,040 BHP Tunnel
Thrusters aft	2 x 1,200 BHP Tunnel

Speed/Consumption	
Max.speed/consumption	16.7 knots at abt. 85 ts/24 hours
Eco. speed/consumption	10.0 knots at abt. 16 ts/24 hours 11.0 knots at abt. 25 ts/24 hours

Dynamic Positioning	
Dynamic positioning	DP 2
Reference system	2 x DGPS, Laser fan beam, HIPAP

Cargo discharge rates	
Base oil	125 m ³ /hour at 10 bar
Brine	2 x 75 m ³ /hour at 24 bar
Cargo fuel oil	250 m ³ /hour at 10 bar
Drill water	250 m ³ /hour at 10 bar
Fresh water:	250 m ³ /hour at 10 bar
Oil based mud	2 x 75 m ³ /hour at 24 bar



Tank plan specification

NAME	DES	VOLUME m ³	FO	FW	WB/DW	RIG CHAIN	LIQUID MUD	BRINE	BASE OIL	CARGO
			(SG=0.9)	(SG=1.0)	(SG=1.025)	(SG=1.025)	(SG=2.8)	(SG=2.0)	(SG=0.9)	FO (SG=0.9)
			WEIGHT mts	WEIGHT mts	WEIGHT mts	WEIGHT mts	WEIGHT mts	WEIGHT mts	WEIGHT mts	WEIGHT mts
T200	MDO/GO STORAGE TANK S	126	113							
T201	MDO/GO STORAGE TANK P	83	75							
T202	MDO/GO STORAGE TANK S CC	263	237							
T203	MDO/GO STORAGE TANK P CC	263	237							
T208	MDO/GO STORAGE TANK S CC	74	67							
T209	MDO/GO STORAGE TANK P CC	74	67							
T300	FW SIDE TANK FWD S	165		165						
T301	FW SIDE TANK FWD P	165		165						
T302	FW SIDE TANK AFT S	144		144						
T303	FW SIDE TANK AFT P	144		144						
T400	BW/DW FORE PEAK TANK C	256			263					
T401	BW/DW DB TANK C	160			164					
T402	BW/DW DB TANK S	81			83					
T403	BW/DW DB TANK P	113			116					
T404	BW/DW DB TANK C	117			120					
T405	BW/DW DB TANK S	106			108					
T406	BW/DW DB TANK P	95			98					
T407	BW/DW TANK/CHAIN LKR. S	339			347	347				
T408	BW/DW TANK/CHAIN LKR. P	339			347	347				
T409	BW/DW DB TANK S	106			109					
T410	BW/DW DB TANK P	106			109					
T411	BW/DW DB TANK C	189			194					
T412	BW/DW DB TANK S	102			105					
T413	BW/DW DB TANK P	105			107					
T414	BW/DW SIDE TANK S	159			163					
T415	BW/DW SIDE TANK P	168			172					
T416	BW/DW STABILIZER TANK C	307			315					
T417	BW/DW AFT PEAK TANK S	139			142					
T418	BW/DW AFT PEAK TANK P	137			140					
T600	LIQUID MUD TANK FWD S	169					472	337	152	152
T601	LIQUID MUD TANK FWD P	169					472	337	152	152
T602	LIQUID MUD TANK AFT S	132					371	265	119	119
T603	LIQUID MUD TANK AFT P	132					371	265	119	119
T700	BRINE TANK C	150						300	135	135
T800	BASE OIL TANK C	147						293	132	132
WEIGHT in mts			795	618	3,203	694	1,685	1,797	809	809
VOLUME in m ³			884	618	3,125	677	602	899	899	899

All basis 100 % volume

Tween deck

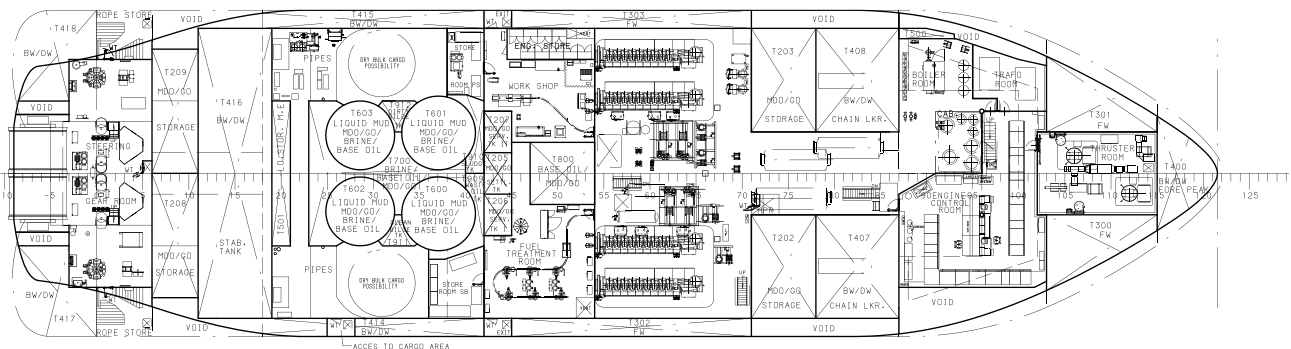



For further information and enquiries please contact:

DENMARK
COPENHAGEN

Visiting address: **Postal address:**
Gl. Lundtoftevej 7 50 Esplanaden
2800 Lyngby 1098 Copenhagen K
Denmark Denmark

Phone: +45 3363 3363
Duty phone: +45 4054 3363

E-mail:
MSSCOMSOU@maersk.com covering
West Africa, South America and Caribbean
MSSCOMNOR@maersk.com covering all other areas
MSSCOMPRJ@maersk.com covering subsea work
and special projects world wide.

UNITED KINGDOM
ABERDEEN

Maersk Supply Service UK Limited
City Wharf
Ship Row
Aberdeen
AB11 5BY
United Kingdom

Phone: +44 1224 243243
E-mail: **ABZMSS@maersk.com**

CANADA
ST. JOHN'S

Seabase Limited
Suite 300, Baine Johnston Centre
10 Fort William Place
St. John's, Newfoundland
A1C 1K4
Canada

Phone: +1 709 737 0600
E-mail: **PAUL.LOCKE@seabase.ca**

BRAZIL
RIO DE JANEIRO

Maersk Supply Service Apoio Maritimo Ltda.
Praia do Flamengo 154, 2nd Floor
22210-906 Rio de Janeiro - RJ
Brazil

Phone: +55 21 3032 2800
E-mail: **RIOMSSCOM@maersk.com**



SINGAPORE
SINGAPORE

Maersk Supply Service
10-00 Southpoint
200 Cantonment Road
Singapore 089763
Republic of Singapore

Phone: +65 6323 8315
E-mail: **SINMSS@maersk.com**

EGYPT
CAIRO

Maersk Egypt SAE
City Stars, Star Capital A2, 13th Floor
Omar Ibn El Khattab Street
Heliopolis
Cairo
Egypt

Phone: +20 2 480 1010
E-mail: **AMR.ELBIBANY@maersk.com**

ANGOLA
LUANDA

Maersk (Angola) Lda.
Rua Major Kanhangulo, no. 290 R/C
Largo do Ambiente
Luanda
Angola

Phone: +244 927 673 852
E-mail: **LADMSS@maersk.com**

NIGERIA
LAGOS

Maersk Nigeria Ltd.
6th Floor, Kazuma Plaza
2-4 Ede Street
Apapa
Lagos
Nigeria

Phone: +234 803 4210 023
E-mail: **LOSMSS@maersk.com**



This brochure is intended for general information only.
Maersk Supply Service makes no warranties about accuracy or completeness of any information contained herein.